

MEG

MATERIAL EXTERIOR GRADE



MEG

ABET LAMINATI

Unlimited selection

MAMPORT



Large range
of decors available



Thicknesses from
2, 3, 4, 6, 8, 10,
12, 14, 16, 18 mm



Digital Print

PERFECT FOR



Façades



Balconies



Sunscreens



Street Furniture



Outdoor Signage

MEG
MATERIAL EXTERIOR GRADE

BUILDING
FAÇADES



405 Bianco Fiorifera 406 Bianco Fiorifera 804 Silver Blue 475 Origo Fera 819 Bianco MEO 1013 Magnolia 414 Seltia 416 Beige



1801 Orla Ossa 413 Beige Aderina 804 Origo Alaba 1010 Seltia Beige 813 Rosa Violeta 890 Terra D'Orlino 837 Samarkand 1010 Origo Alaba



894 Viola Fama 898 Bruno Fardis 1070 Choccolati 488 Origo Tema 871 Origo Scuro 1031 Origo Perla 879 Origo Grafite 474 Origo Lupo



421 Nero 868 Origo Medio 867 Origo Cielo 449 Sanna Bull 448 Matori 441 Pini Field 842 Verde Suli 344 Jean



1020 Origo Caelina 1053 Muzha 1024 Blu Anagora 105 Blu Italia 840 Verde Lilla 400 Verde Lario 440 Verde Sicario 496 Blu California



888 Blu Fiamma 891 Blu Cobalto 1004 Blu Venezia 1061 Blu Verde 487 Acqua Polvere 1000 Sanna 847 Acqua 839 Blu Firenze



852 Blu Blu 846 SunnyView 1004 Orla MEO 1012 Orla Polena 891 Scotch Brown 820 Rosso Terzo 1000 Rosso MEO 832 Rosso Loro 898 Viola Oglio 1003 Malavita

ABET LAMINATI



Unlimited selection



MAMPORT



MEG

ABET LAMINATI

Unlimited selection



RAINSCREENS



Protects
from rain
and allows
the ventilation



Resistant
to natural
weathering



Antistatic,
good fire
behavior



Easy to work
and clean,
eco-sustainable

In the early 50s the Building Research Station in UK showed the advantages of having a ventilated cavity in front of the building wall.

Alcoa Building (1951 | 1953 | PITTSBURGH | PENNSYLVANIA)

VENTILATE FACADE | BENEFITS

ABET LAMINATI

Unlimited selection



The building wall is protected from the hot radiation in summer

The chimney effect generates ventilation that makes the temperature decrease

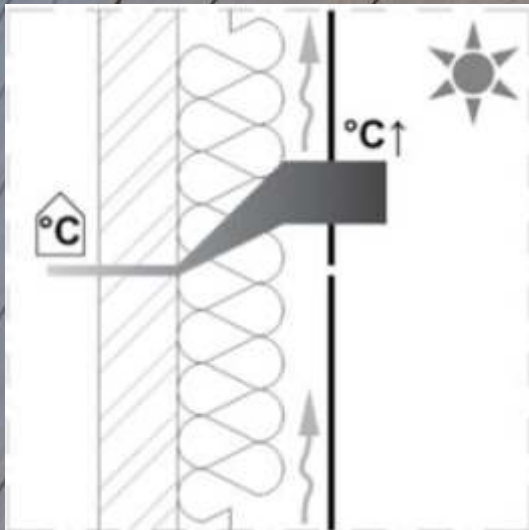

The air cavity is a thermal intermediate between the internal and external sides

The panels protect the walls from the bad weather conditions

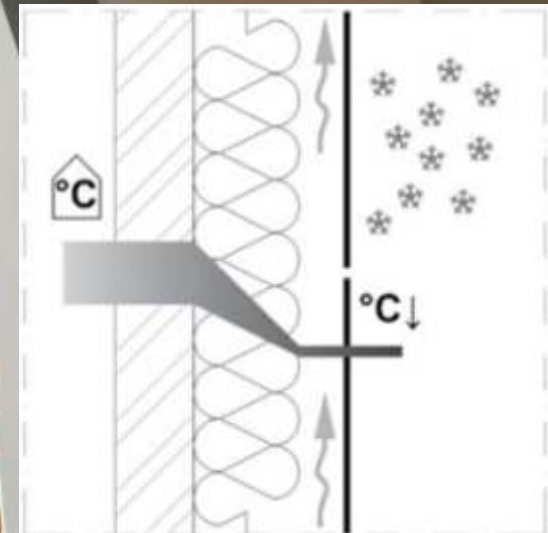

MEG FIXING SYSTEMS | Visible mechanical fixing on an aluminium backing structure

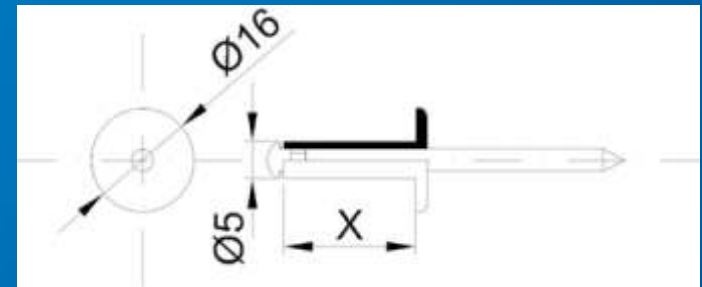
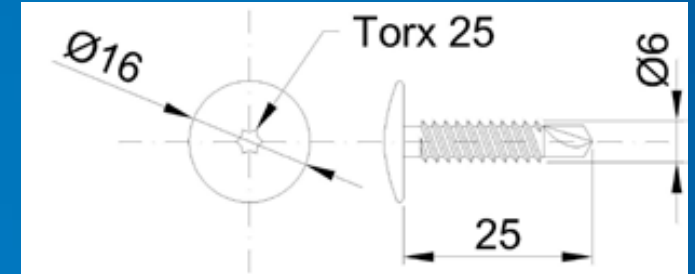

MEG FIXING SYSTEMS | Invisible fixing with overlapping panel strips
(weatherboarding or lap siding)

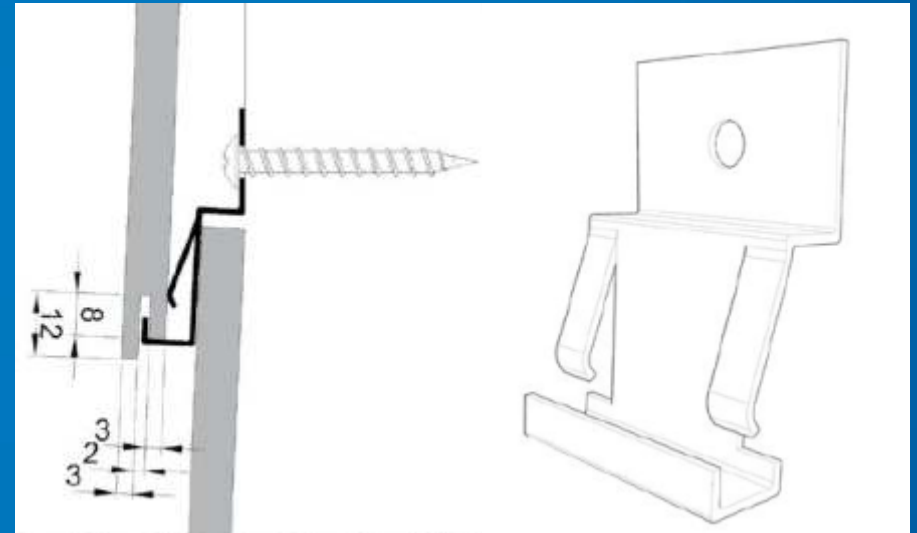

MEG FIXING SYSTEMS | Invisible fixing with profiled edged panels in horizontal running aluminium hook profile

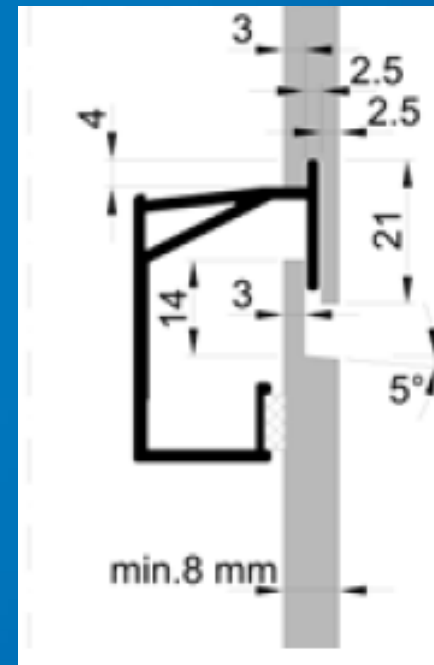

MEG FIXING SYSTEMS | Invisible fixing with profiled edged panels in horizontal running aluminium hook profile

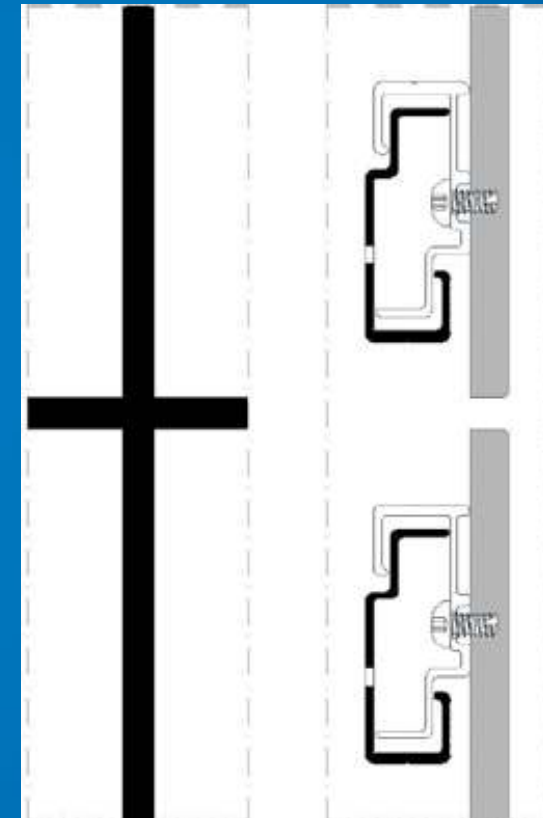

MEG FIXING SYSTEMS | Gluing on aluminium substructure

ABET LAMINATI

Unlimited selection



- Dynamic wind strenght
- Distance from MEG panels
- Calculate panel expansion with fix and movable fixing
- Air cavity behind the panels
- Measure the size of the panels for the layout of your facades
- Calculate the isolation materials tickness
- Vertical aluminium sub-structure dilatation.
- Anchoring in the proper way the aluminium or wood structure to the existing building



The «FIXED POINT» must be placed in the centre of every MEG panels in order to not allow further changes of position.

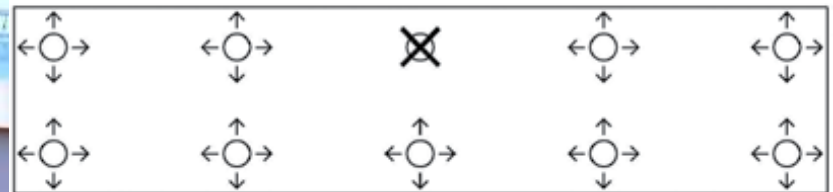
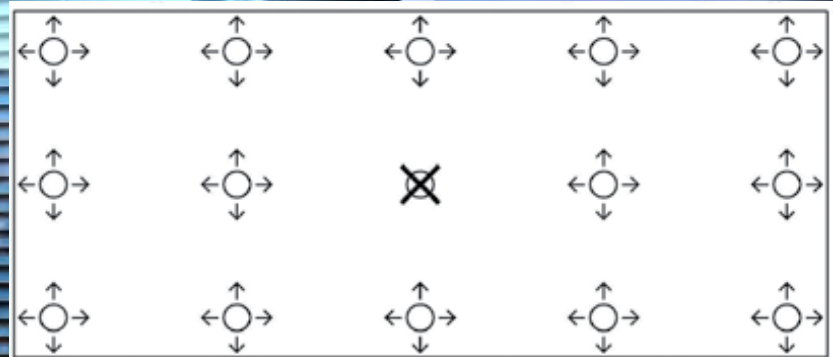

Rock Wool

Glass Wool

Polystyrene extruded

Polystyrene extruded with graphite

Structural polyurethane

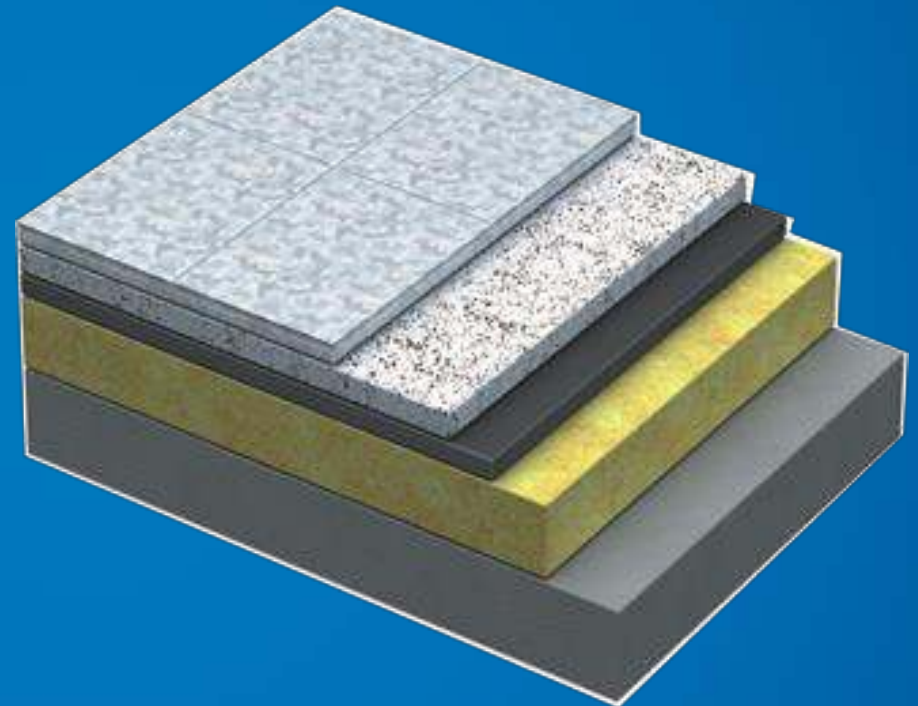

MEG | Casa O | 2015 | CAGLIARI | ITALY

ABET LAMINATI

Unlimited selection



MEG | Casa O | 2015 | CAGLIARI | ITALY

ABET LAMINATI

Unlimited selection



MEG | TRAIN STATION | 2012 | KOKSIJDE | BELGIO

ABET LAMINATI

Uniformal polimerizacija



MEG | TRAIN STATION | 2012 | KOKSIJDE | BELGIUM

ABET LAMINATI

Unlimited selection



MEG | TRAIN STATION | 2012 | KOKSIJDE | BELGIUM

ABET LAMINATI

Unlimited selection



MAMPORT



MEG | Triennale | 2009 | INCHEON | SOUTH KOREA

ABET LAMINATI

Unlimited selection



MEG | Triennale | 2009 | INCHEON | SOUTH KOREA

ABET LAMINATI

Unlimited selection



MEG | Tuincentrum Pelckmans | 2010 | TURNHOUT | BELGIUM

ABET LAMINATI

Unlimited selection



MEG | Tuincentrum Pelckmans | 2010 | TURNHOUT | BELGIUM

ABET LAMINATI

Unlimited selection



MEG | "Nest" Casa Clima | 2011 | CERVIA | ITALY

ABET LAMINATI

Unlimited selection

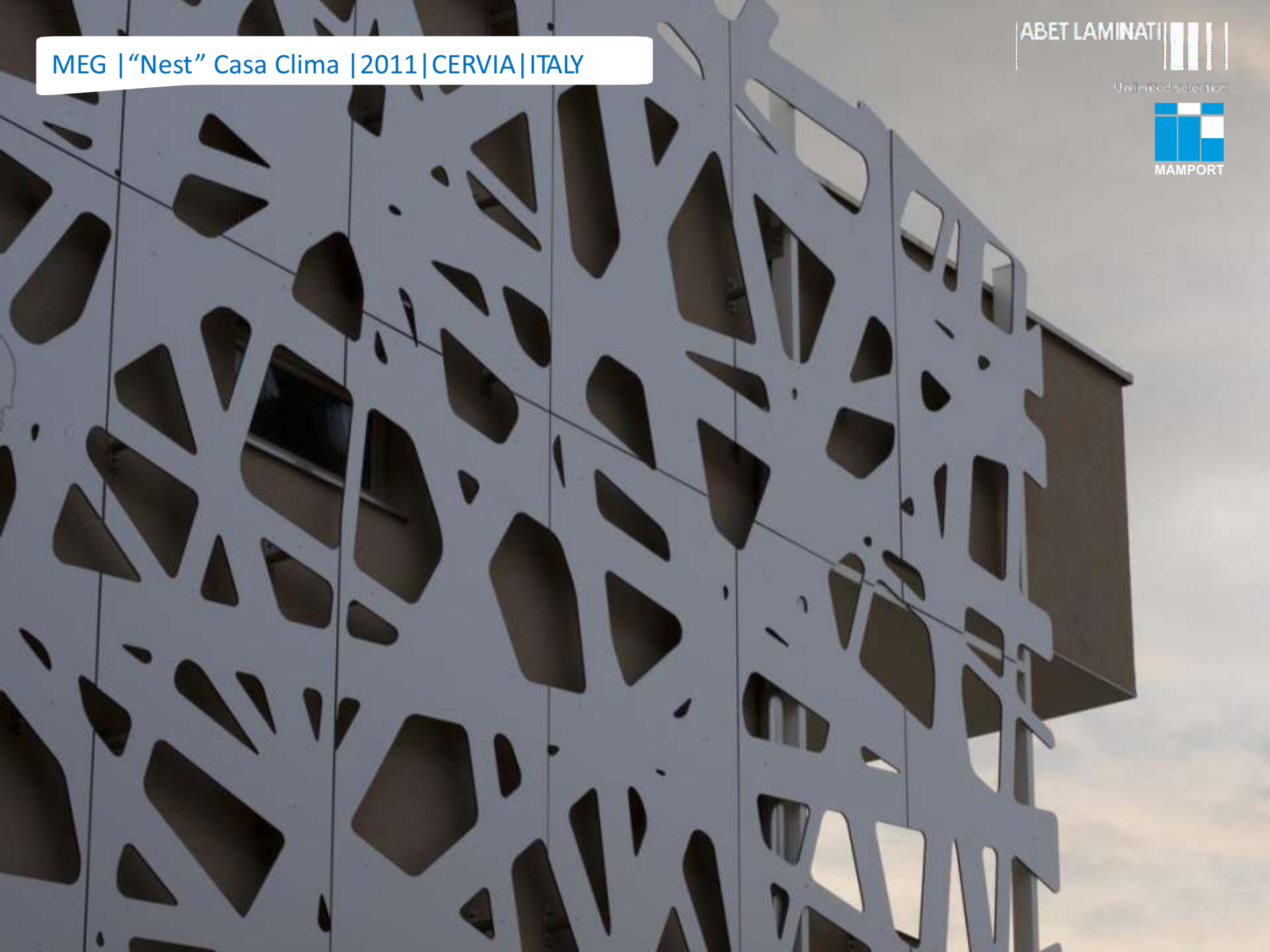

MEG | "Nest" Casa Clima | 2011 | CERVIA | ITALY

ABET LAMINATI

Unlimited inspiration



MEG | RESIDENCE TASSIN | 2014 | FRANCE

ABET LAMINATI

Unlimited selection

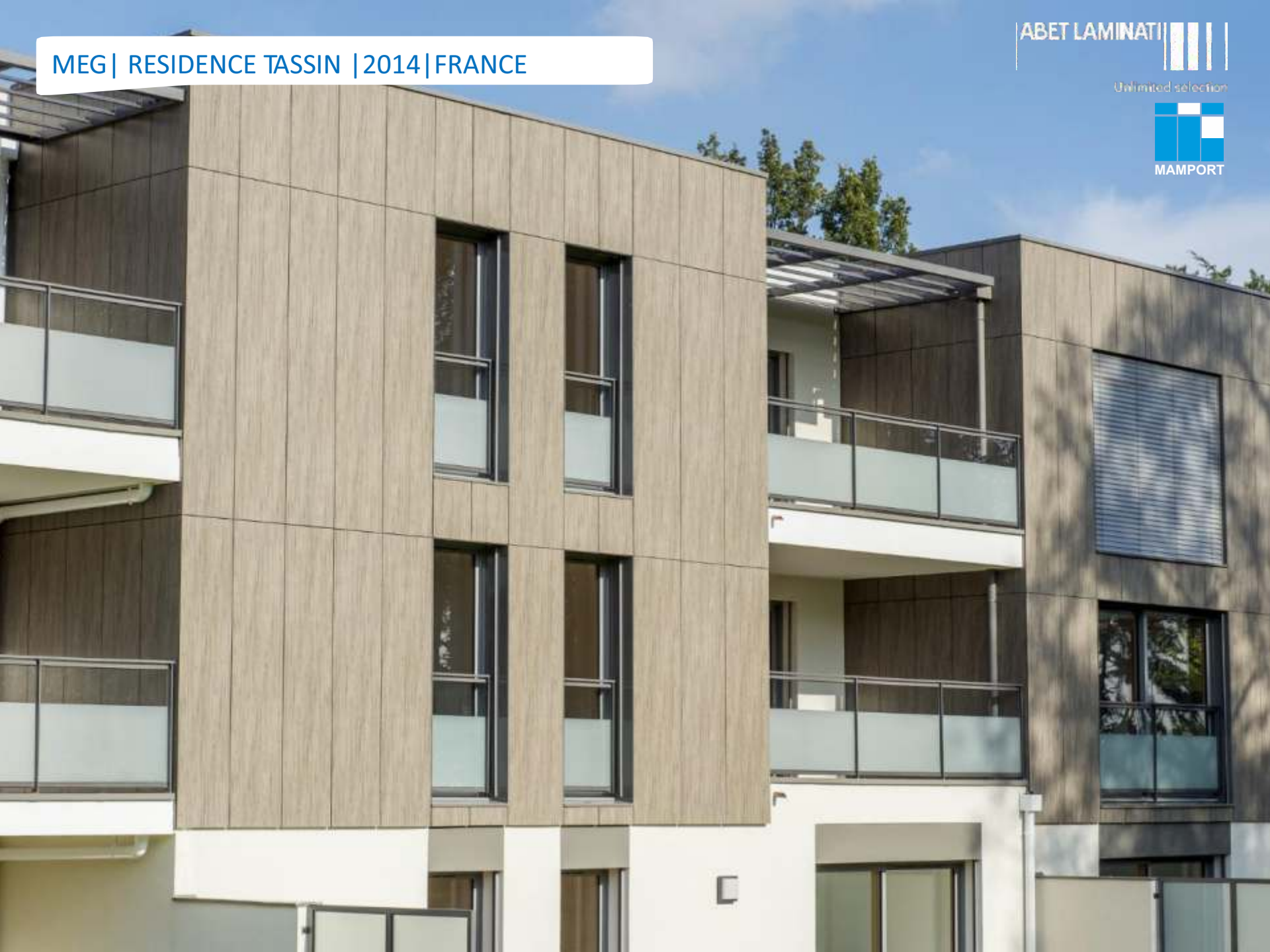

MEG | RESIDENCE TASSIN | 2014 | FRANCE

ABET LAMINATI

Unlimited selection

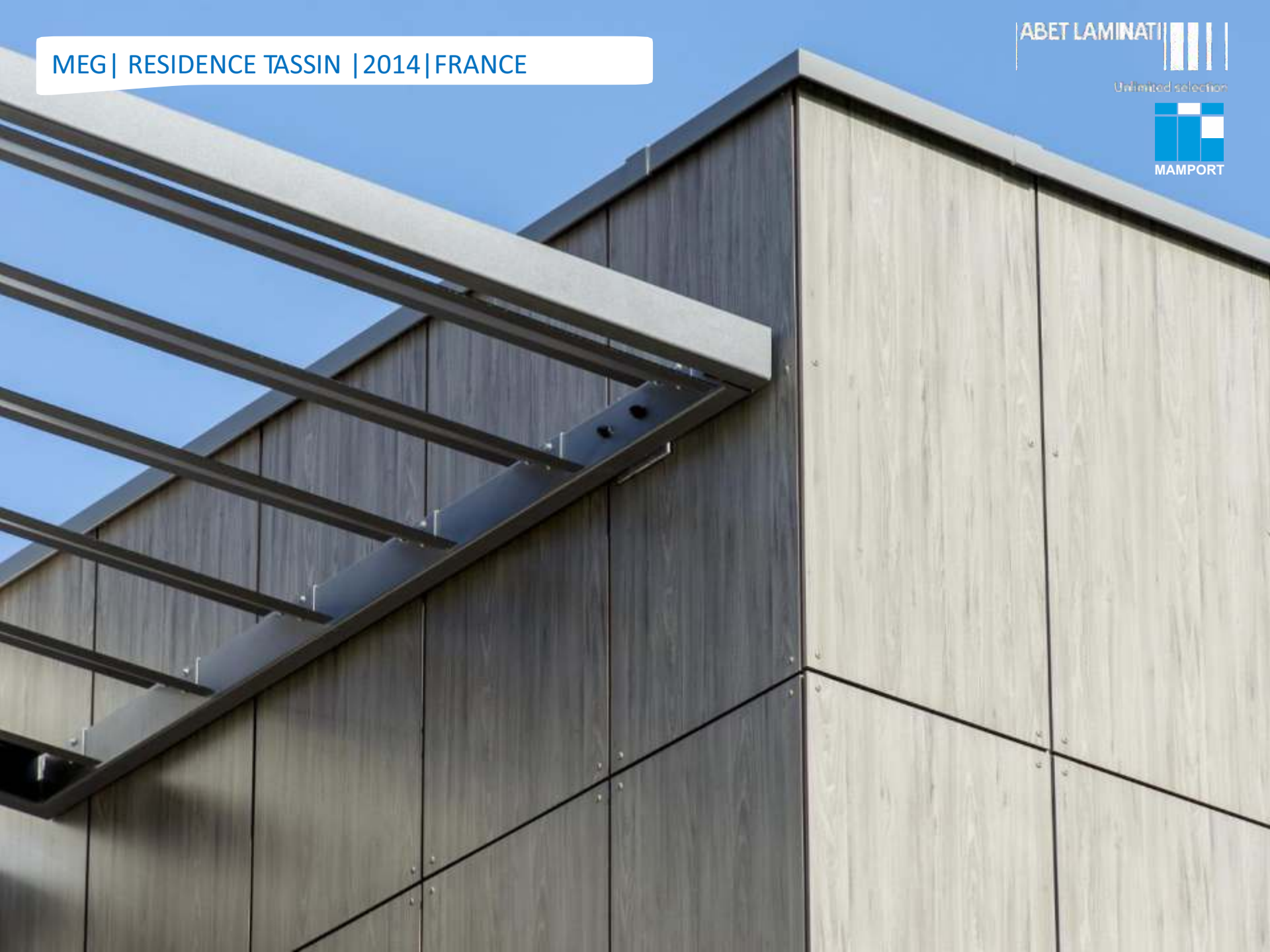



MEG | ABET PARK | 2013 | CHAMBERY | FRANCE

ABET LAMINATI

Uniforment polystirolo



MEG | MUSEO ABET LAMINATI | 2013 | BRA | ITALY

ABET LAMINATI

Unlimited selection



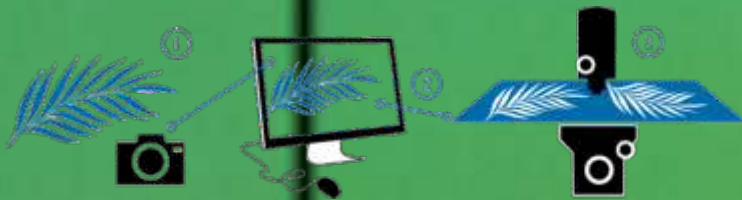

MEG | BRABEL SCHOOL | 2010 | BELGIUM



MEG | DE ZEVEN TORENTJES HOSPITAL | 2011 | BRUGES | BELGIUM

ABET LAMINATI

Unlimited selection



MEG | DE ZEVEN TORENTJES HOSPITAL | 2011 | BRUGES | BELGIUM

ABET LAMINATI

Unlimited selection



MEG | RESIDENTIAL BUILDING | 2014 | LEBANON

ABET LAMINATI

Unlimited selection

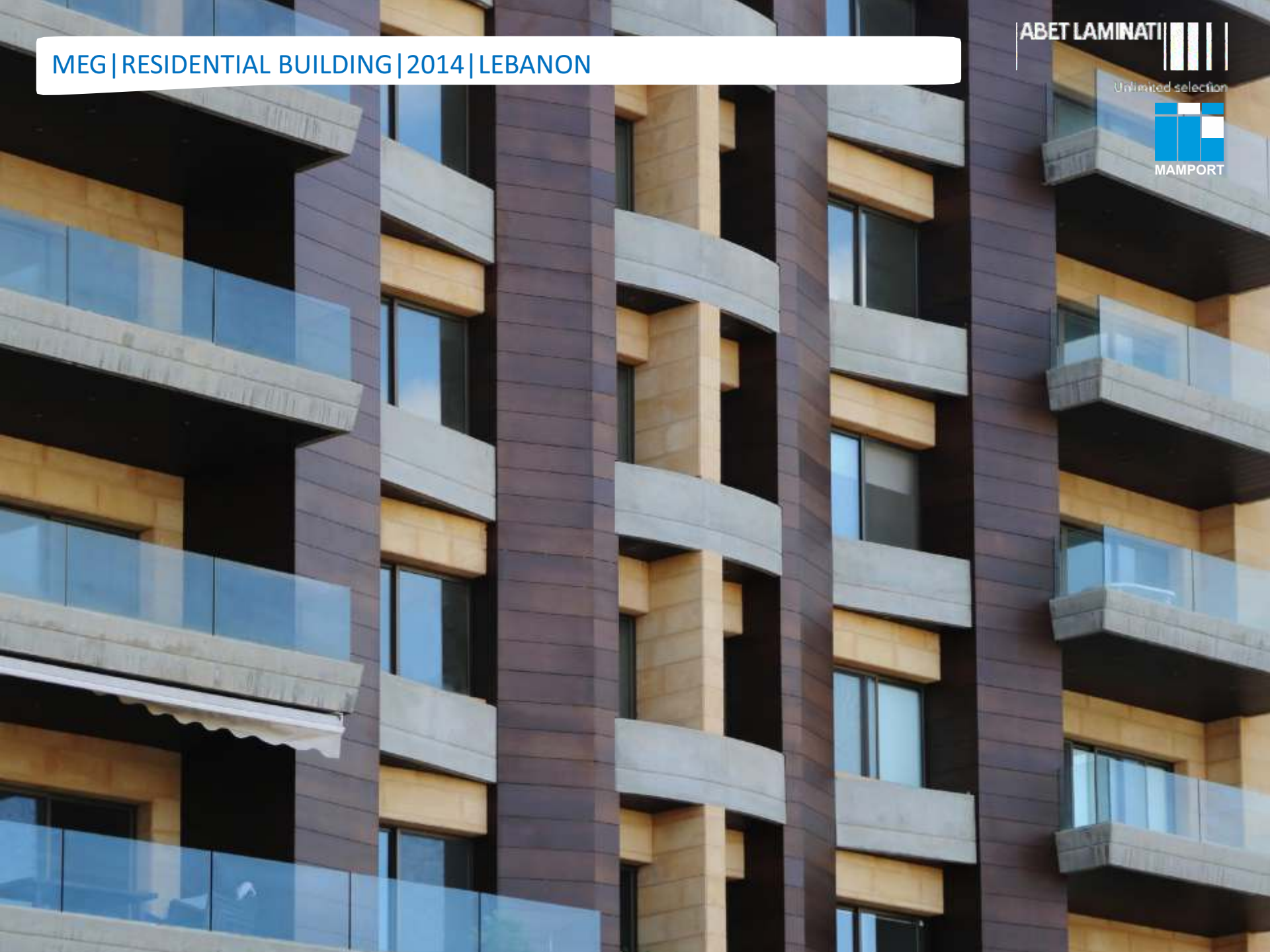



MEG | RESIDENTIAL BUILDING | 2013 | LEBANON

ABET LAMINATI

Unlimited selection



MEG | JOSEPH SFEIR CENTER | 2014 | LEBANON

ABET LAMINATI

Unlimited selection



بنك بيروت
Bank of Beirut

Thank you for your kind attention

